

Tallinna Ülikool

Digitehnoloogiate instituut

Informaatika

VEESÕIDUK

Eksamitöö

Autor: Marvin Helstein

Juhendaja: Kalle Kivi

Tallinn 2020

Autorideklaratsioon

Deklareerin, et käesolev eksamitöö on minu töö tulemus ja seda ei ole kellegi teise poolt varem esitatud. Kõik töö koostamisel kasutatud teiste autorite tööd, olulised seisukohad, kirjandusallikatest ja mujalt pärinevad andmed on viidatud.

03.05.20

(kuupäev)

Marvin Helstein

(autor)

Sisukord

1	Käskude kasutuskohad	1
1.1	Revolved protrusion	1
1.2	Lofted protrusion	1
1.3	Swept protrusion.....	2
1.4	Cutout	2
1.5	Draft.....	3
1.6	Text Profile.....	3
1.7	Rectangular Pattern	4
1.8	Circular Pattern.....	4
1.9	Curved Pattern	5
1.10	Mirror.....	5
1.11	Round.....	6
1.12	Chamfer	6
1.13	Rib.....	7
1.14	Web Network.....	7
1.15	Lip.....	8
1.16	Thin Wall	8
1.17	Bluesurf.....	9
1.18	Cross Curve.....	9
1.19	Stitched Surface	10
1.20	Keypoint Curve.....	10
1.21	Derived Curve.....	11
1.22	Replace Face	11
1.23	Flange.....	12
1.24	Dimple	12
1.25	Louver.....	13

1.26	Bead	13
	Kasutatud allikad.....	14

1 Käskude kasutuskohad

1.1 Revolved protrusion

Console/wheel.par

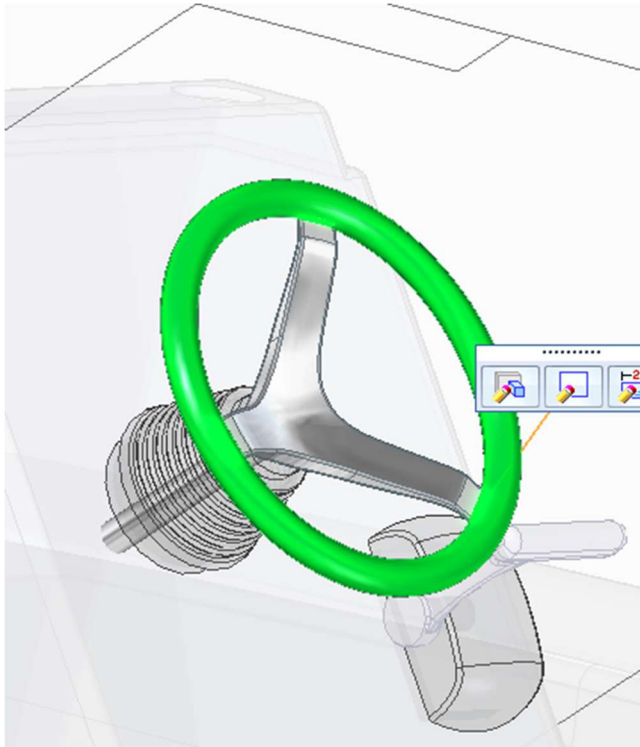

1.2 Lofted protrusion

Boxes/Back well.par

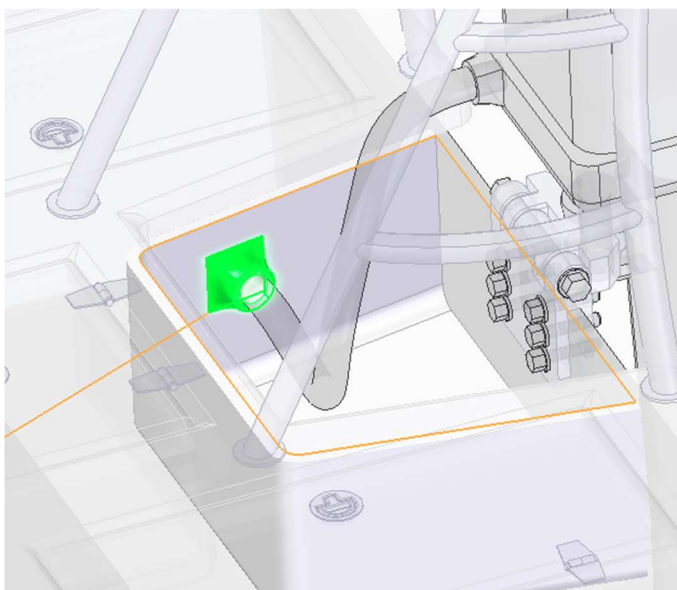

1.3 Swept protrusion

Back Rails.par

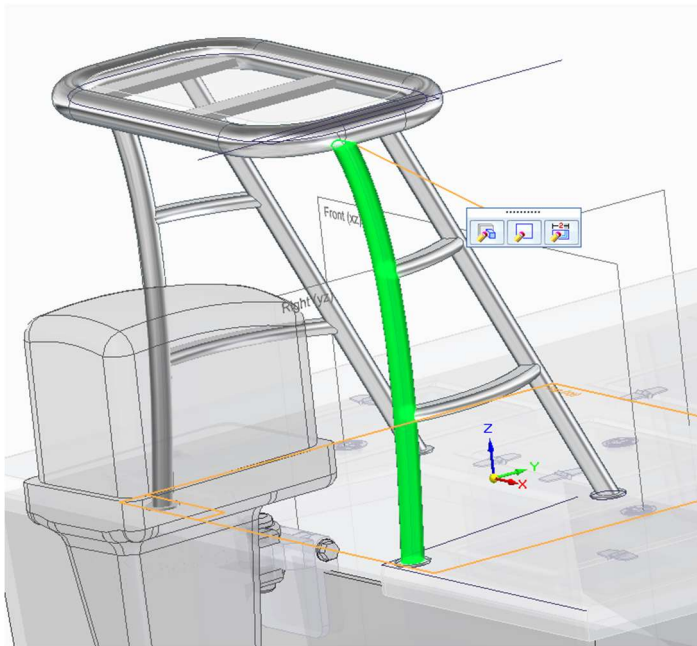

1.4 Cutout

Deck1.par

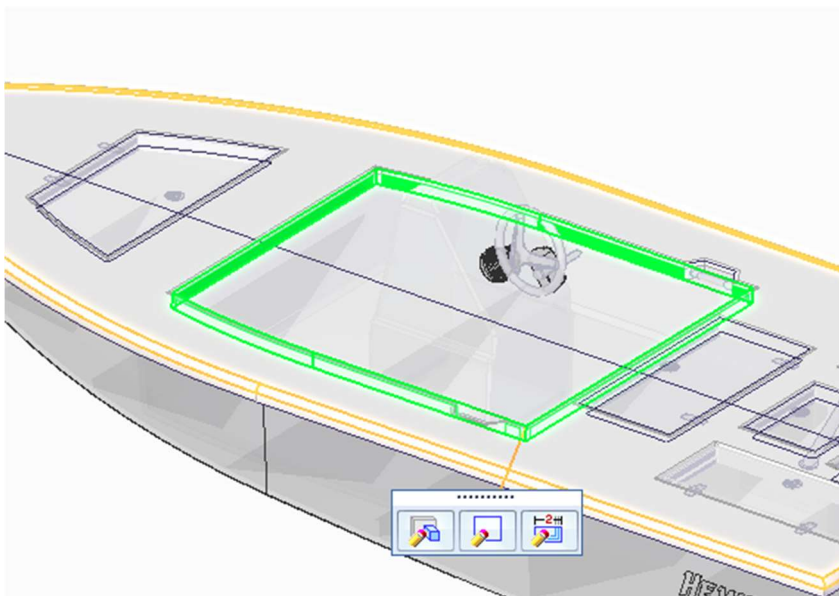

1.5 Draft

Engine/Enginev2.par

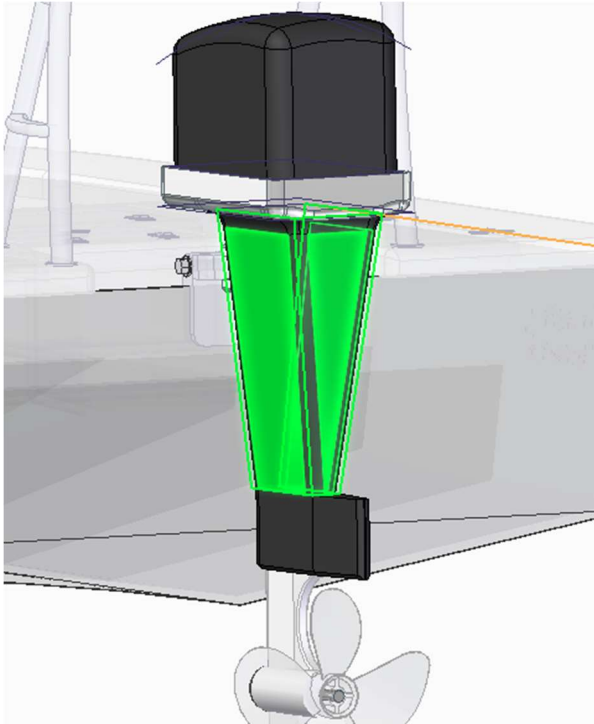

1.6 Text Profile

Hull.par

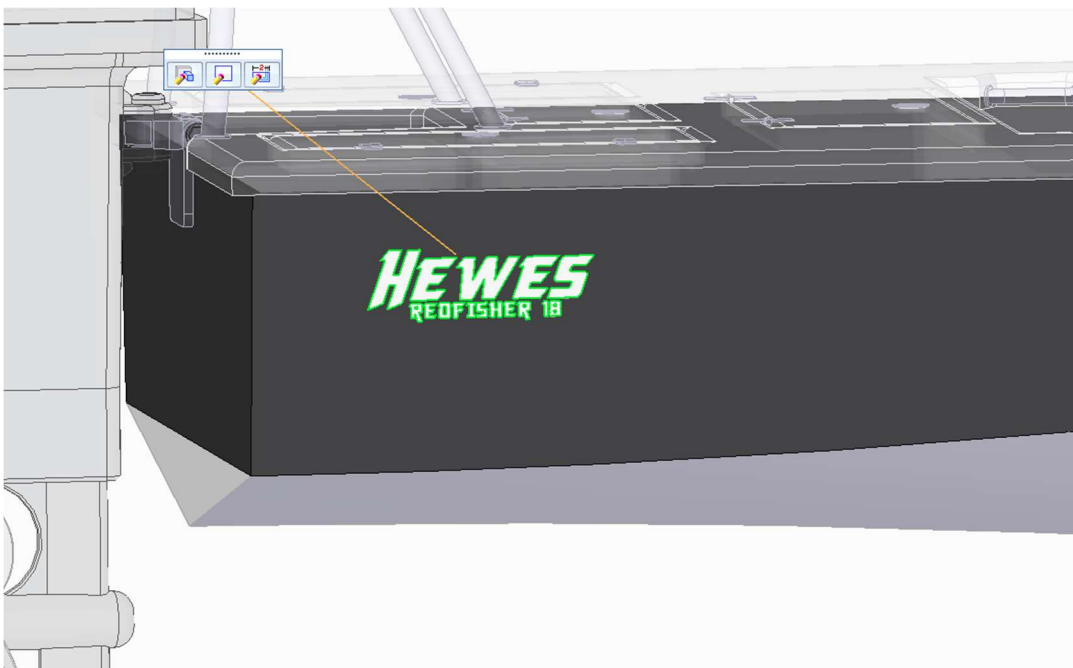

1.7 Rectangular Pattern

Engine/Attachment.par

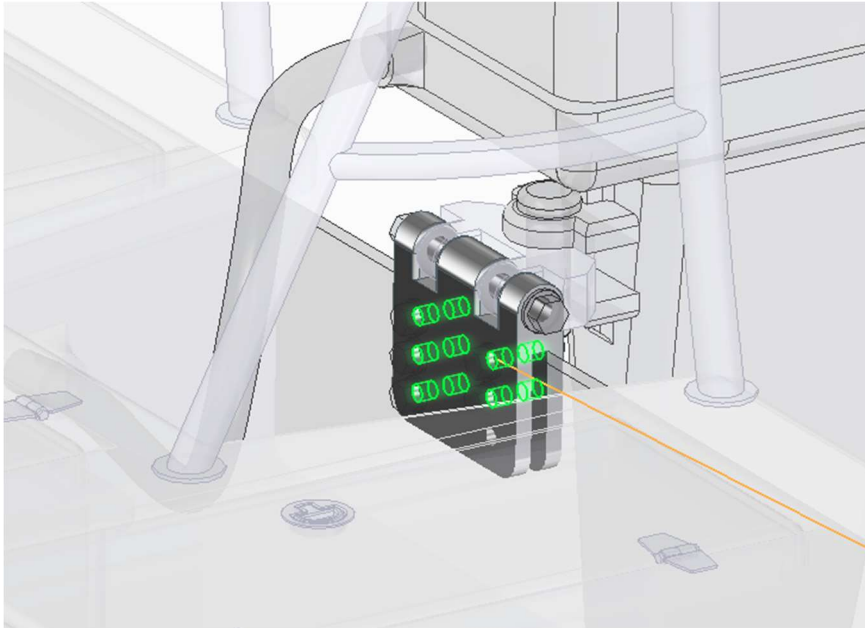

1.8 Circular Pattern

Engine/Propeller.par

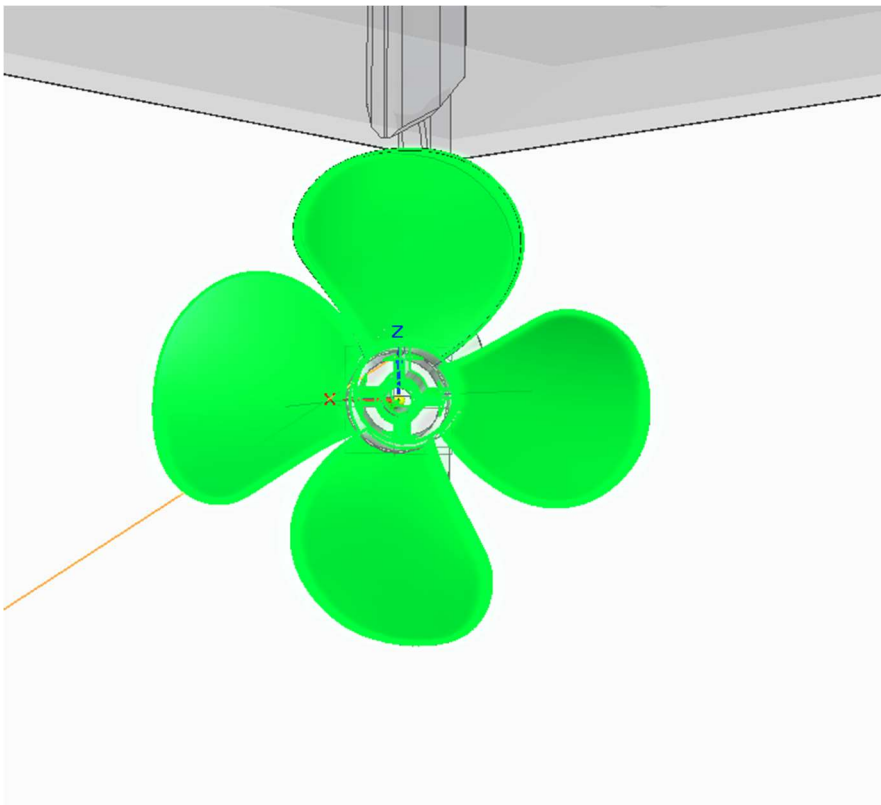

1.9 Curved Pattern

Hull.par

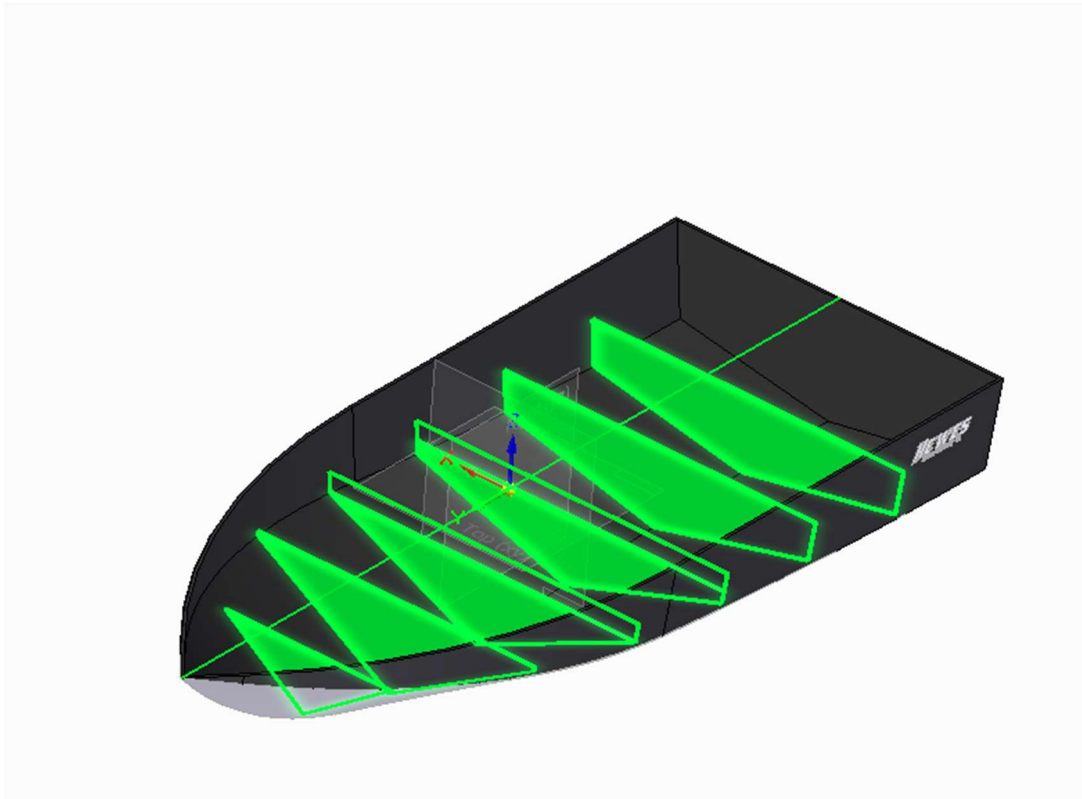

1.10 Mirror

Hull.par



1.11 Round

Deck1.par

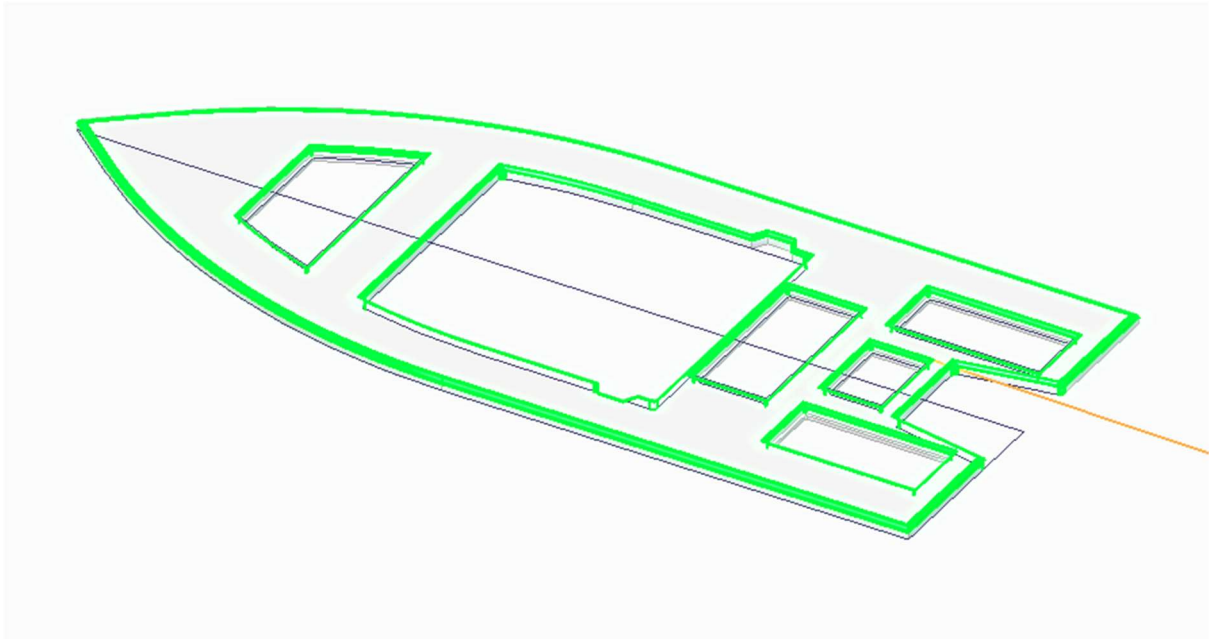

1.12 Chamfer

Engine/Enginev2.par

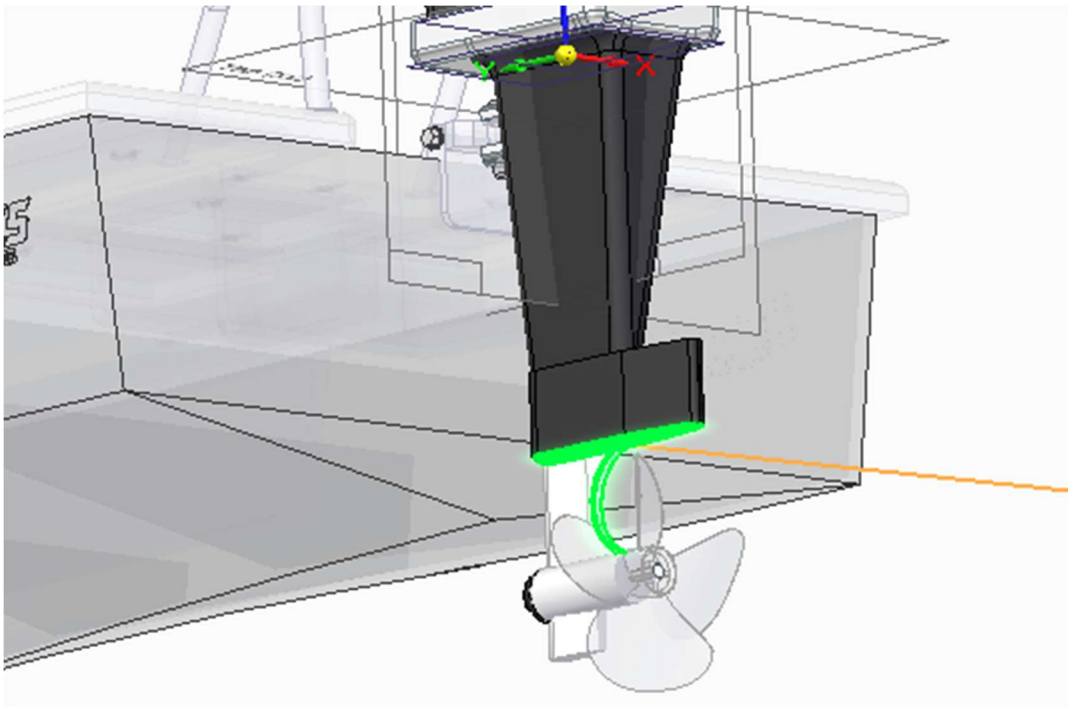

1.13 Rib

Engine/Enginev2.par

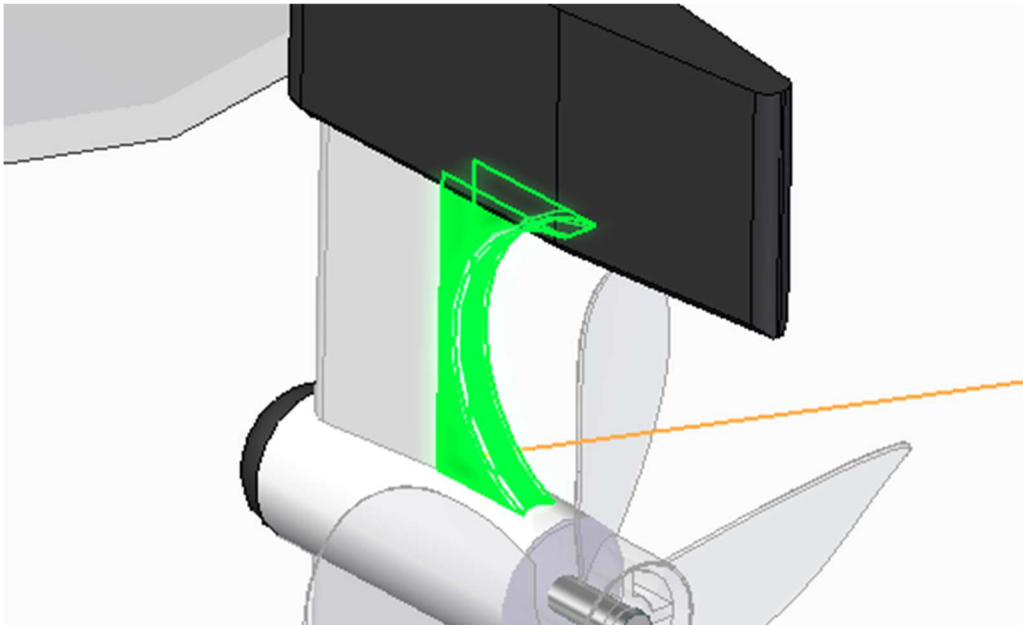

1.14 Web Network

Hull.par

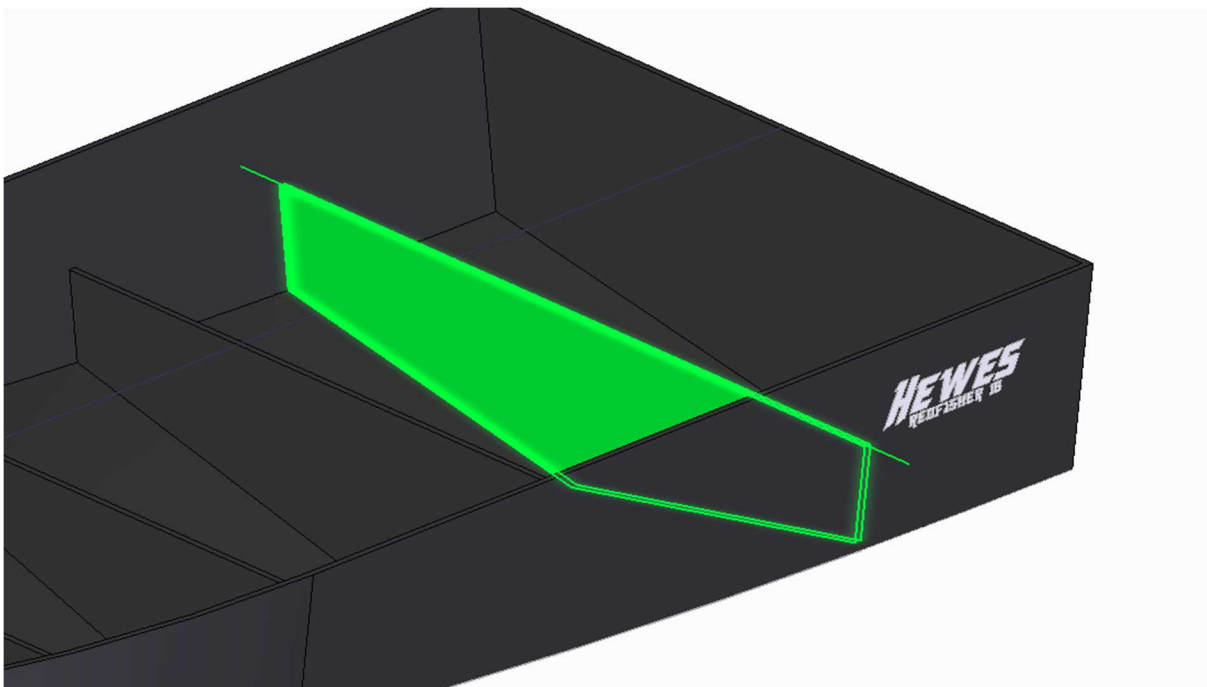

1.15 Lip

Console/Console.par

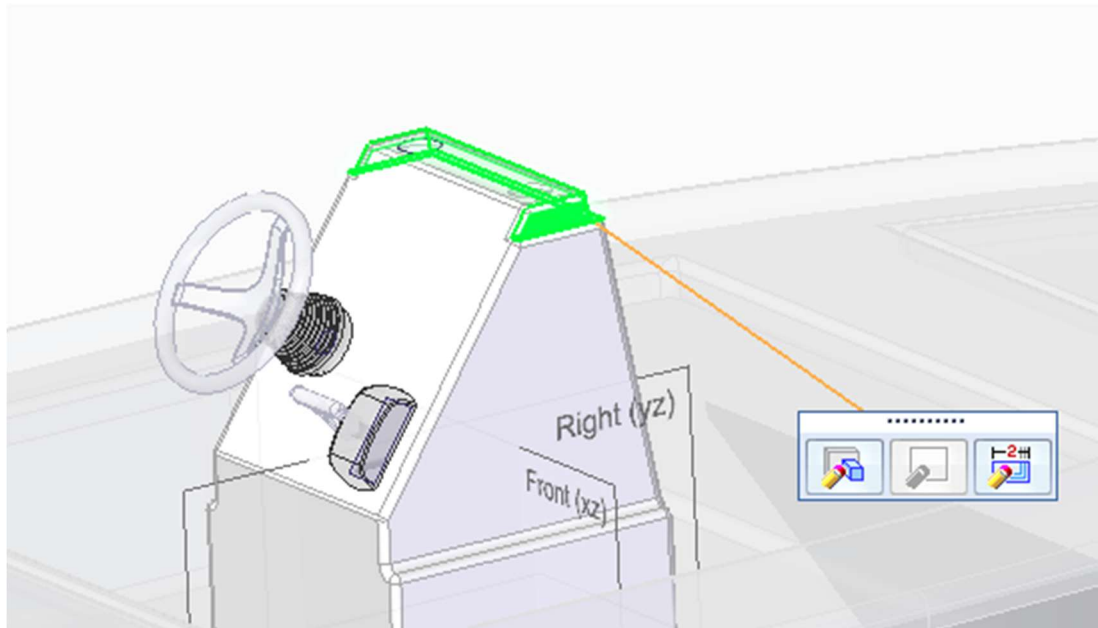

1.16 Thin Wall

Hull.par

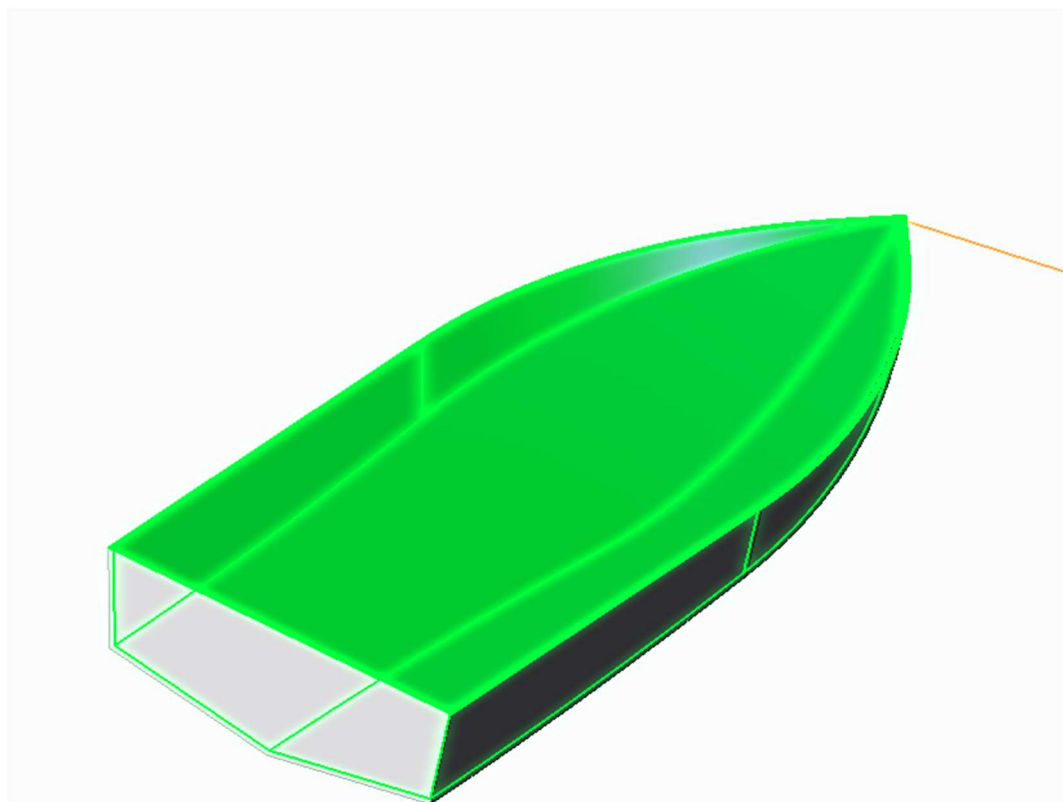

1.17 Bluesurf

Hull.par

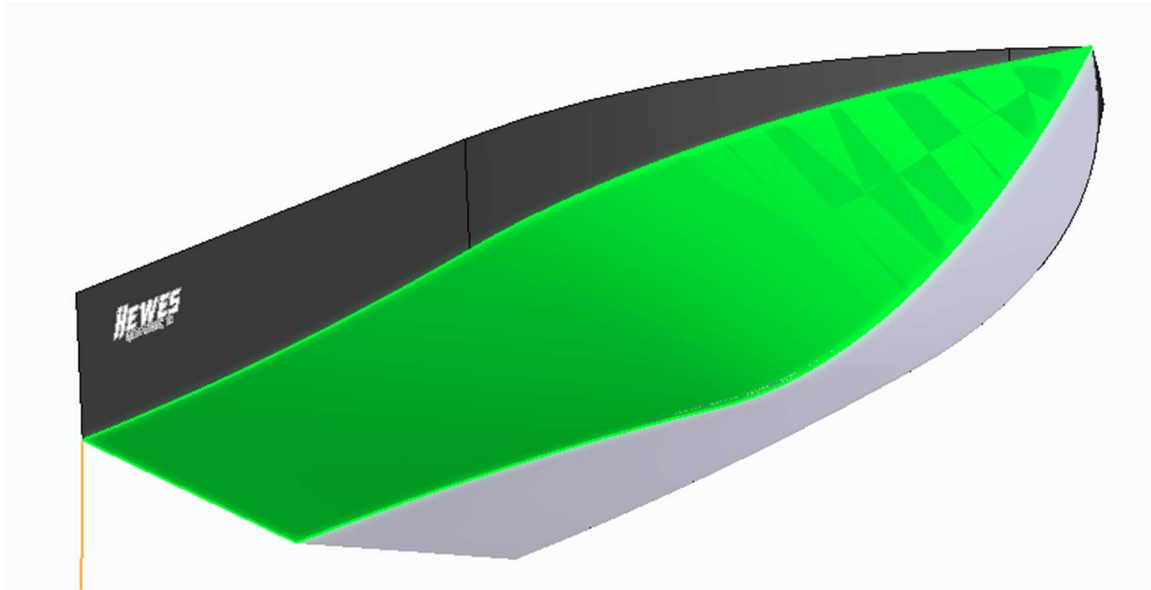

1.18 Cross Curve

Engine/Propeller.par

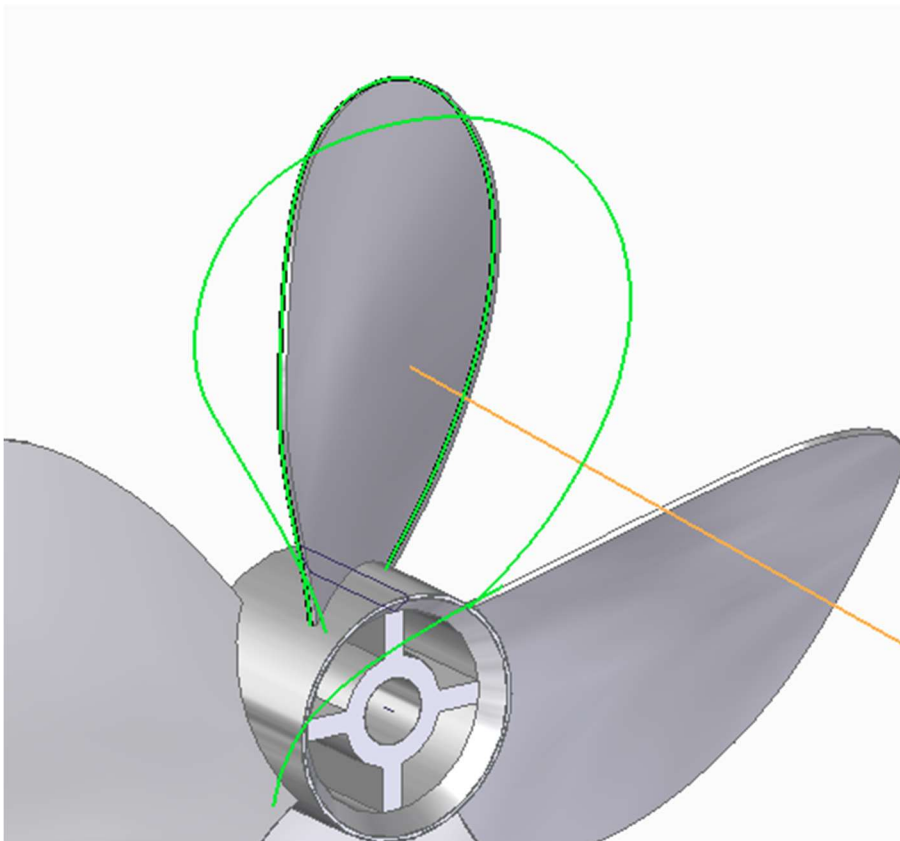

1.19 Stitched Surface

Console/Throttle Lever Body.par

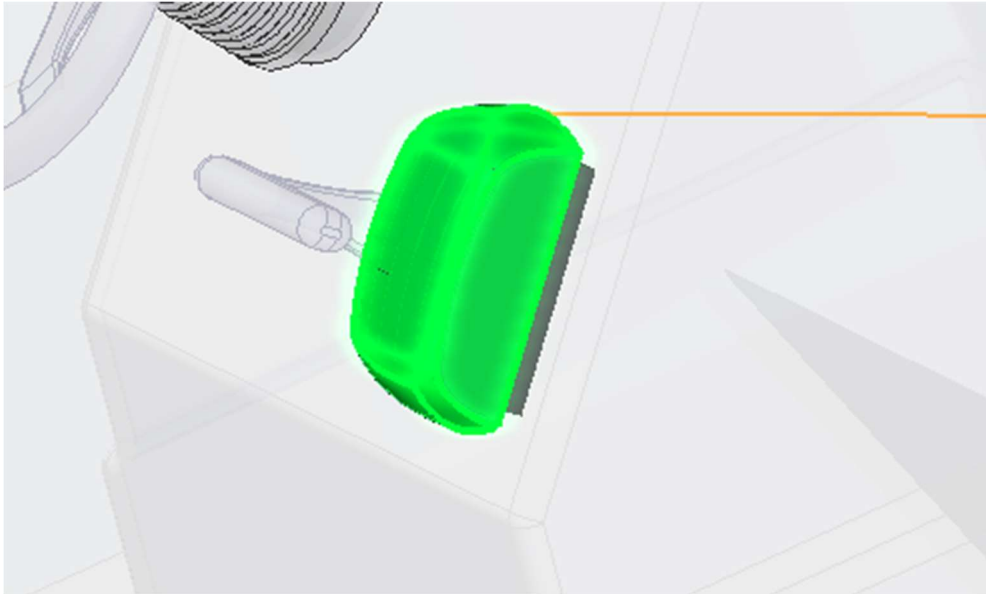

1.20 Keypoint Curve

Engine/Tube.par

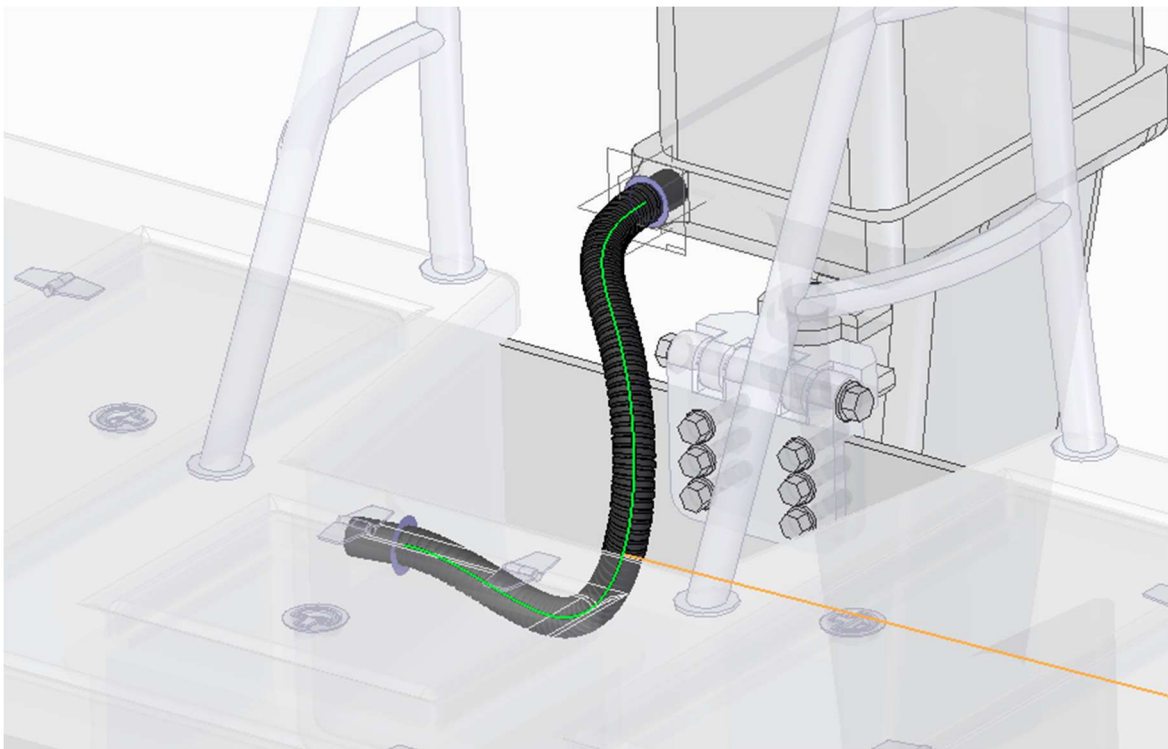

1.21 Derived Curve

Engine/Tube.par

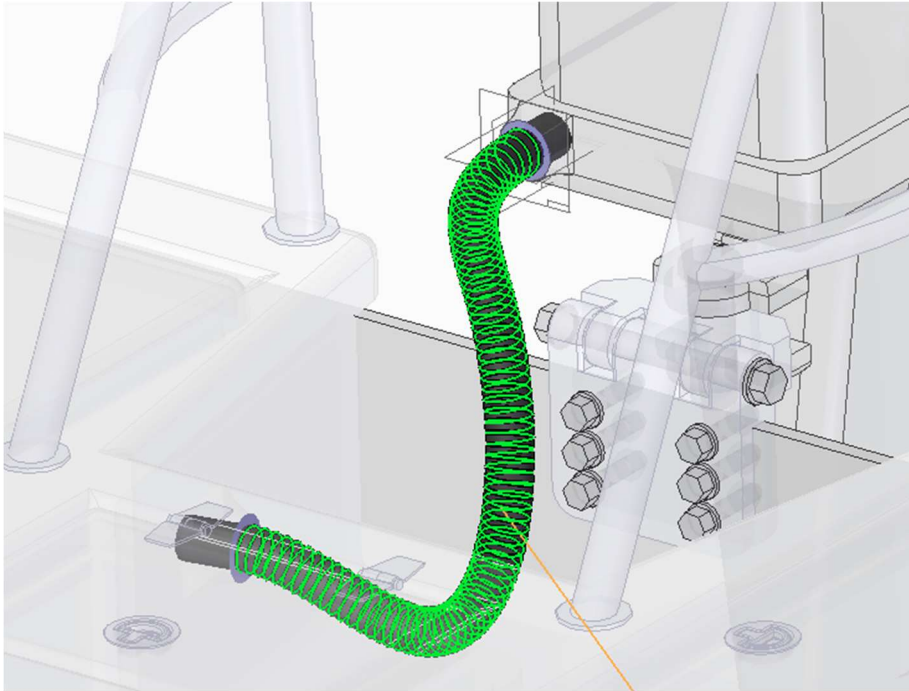

1.22 Replace Face

Hull.par

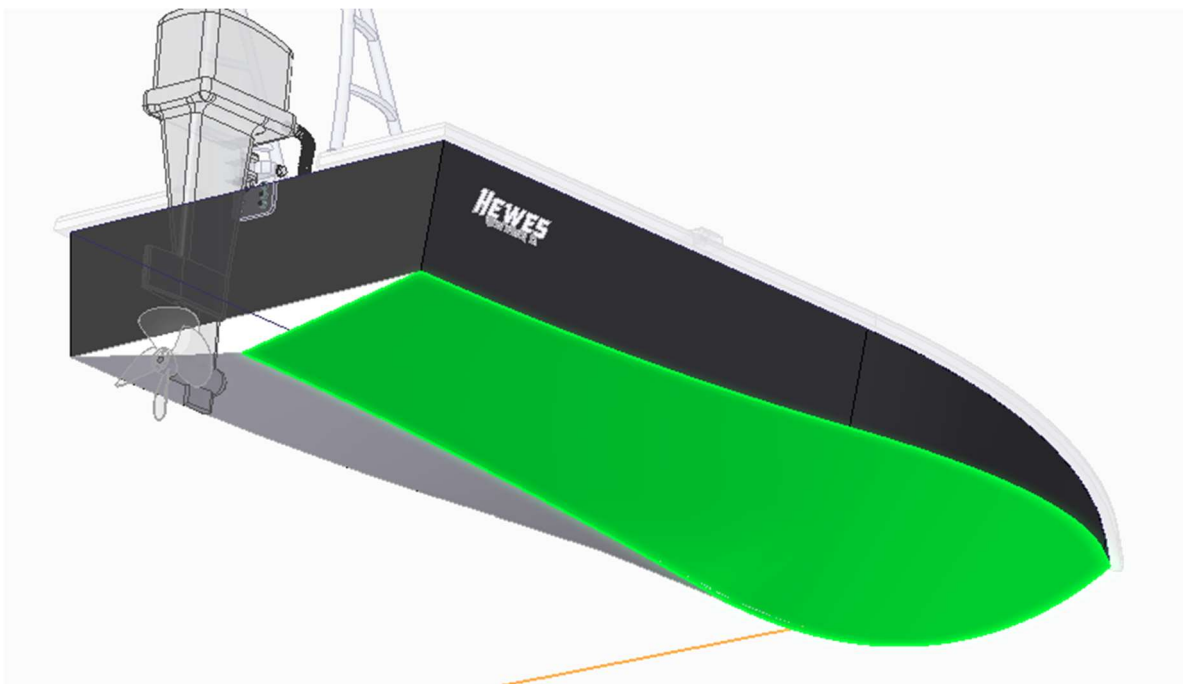

1.23 Flange

Console/Console Lid Frame.psm

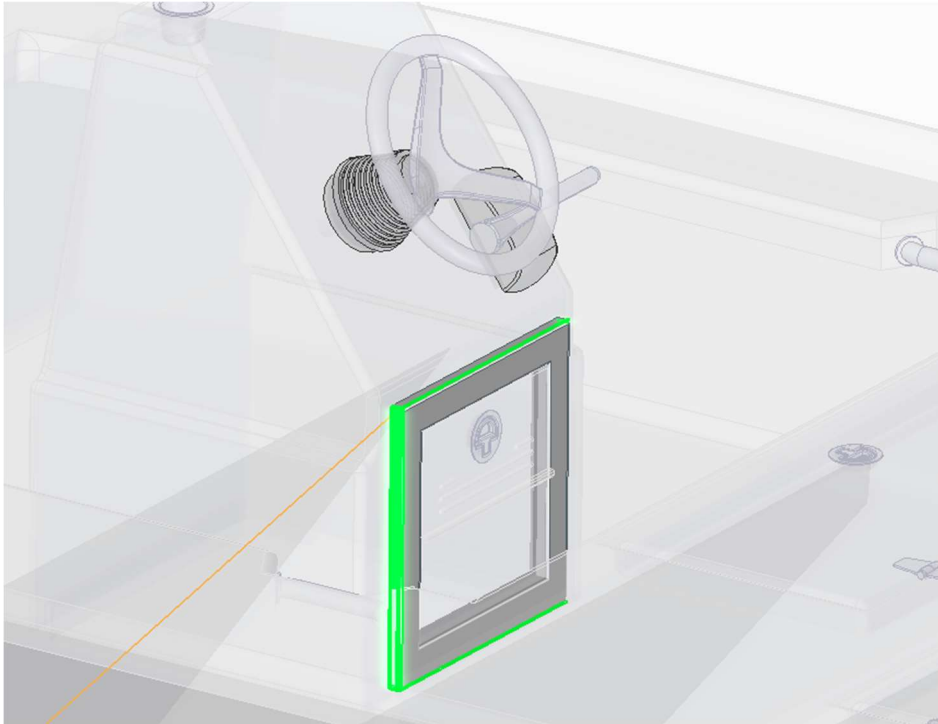

1.24 Dimple

Lids/Lid Handle Base.psm

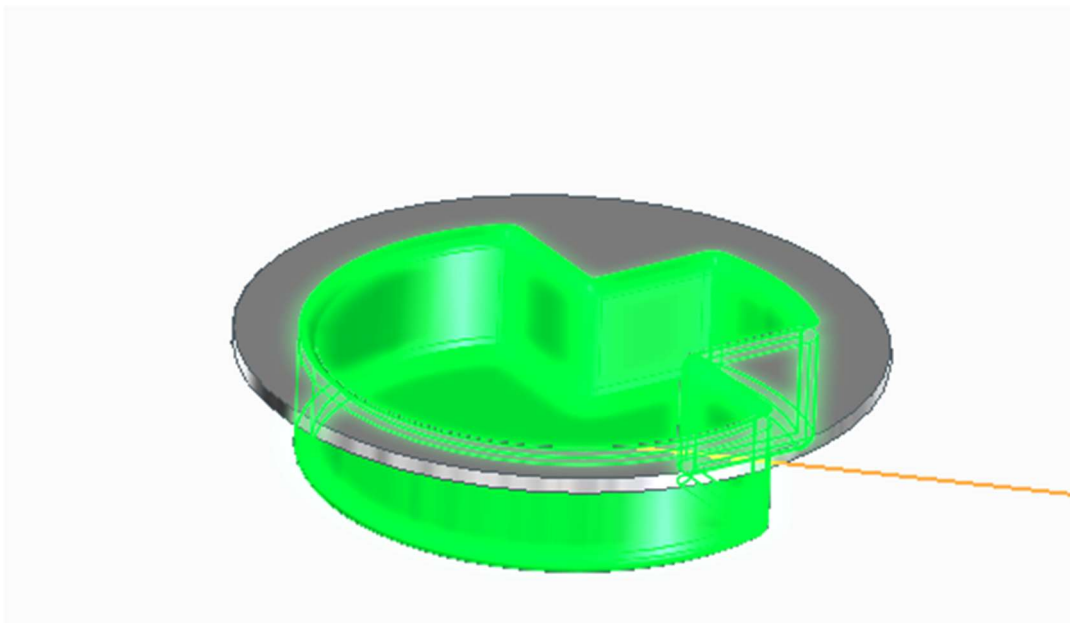

1.25 Louver

Console/Console Lid.psm

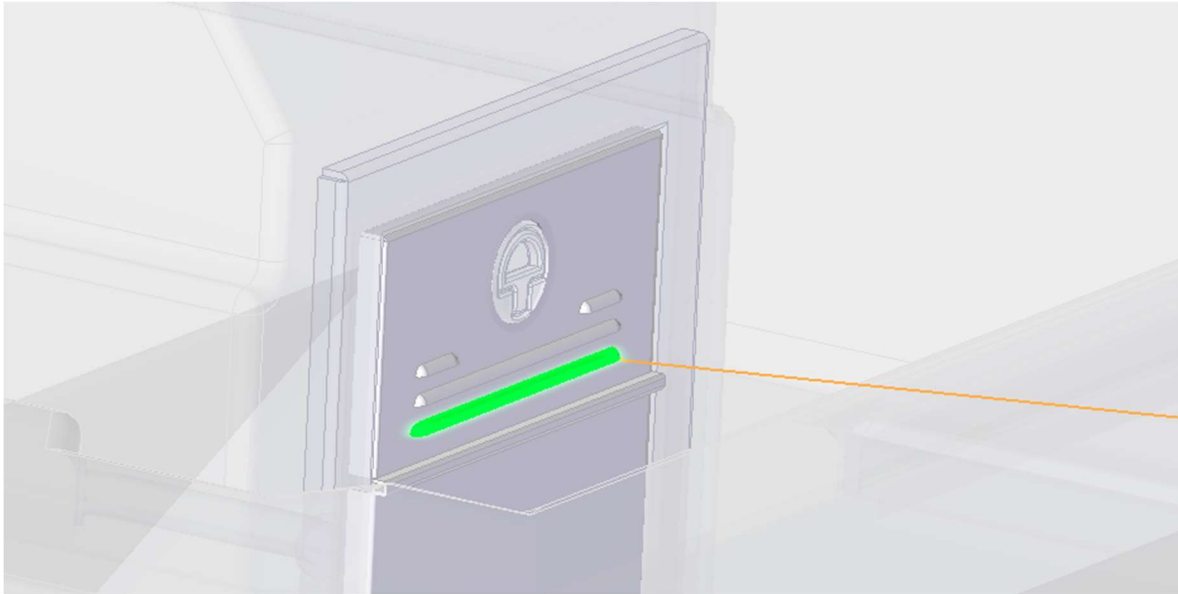

1.26 Bead

Console/Console Lid.psm

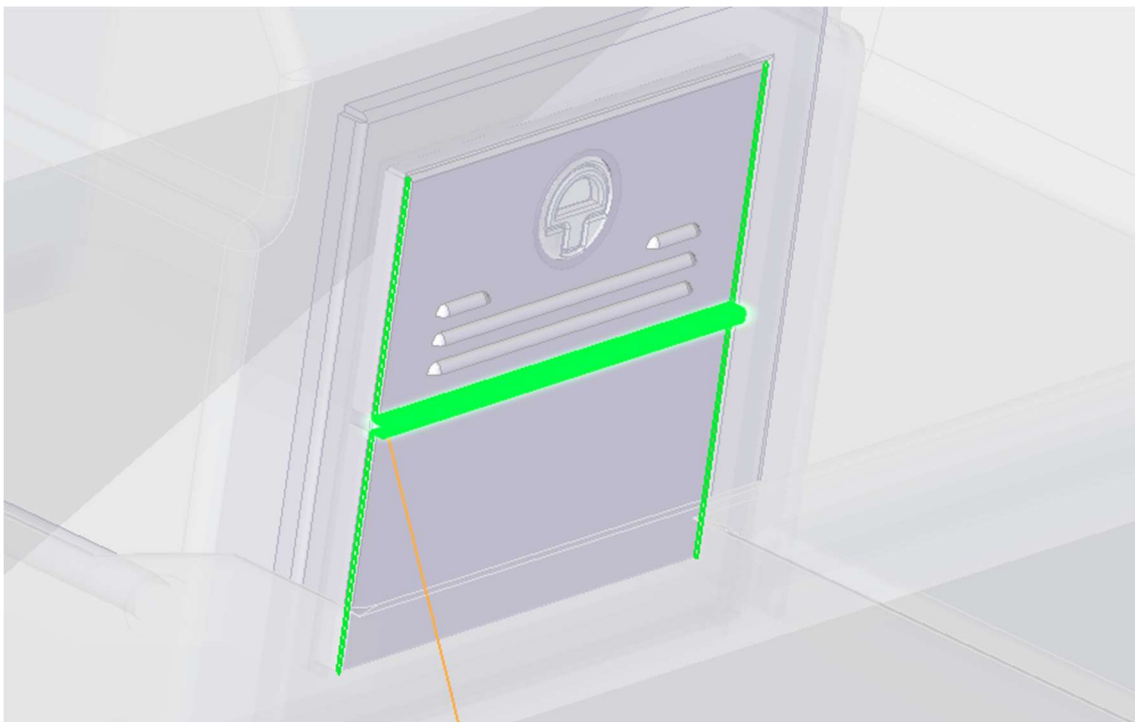

Kasutatud allikad

Mudel põhineb Hewes Redfisher 18 paadil.

Tegemisel on aluseks kasutatud järgmisi allikaid:

<https://www.youtube.com/watch?v=oOSRFyrbhSg>

<https://www.youtube.com/watch?v=HUp3YZ963Gk>

<http://hewes.com/wp-content/uploads/downloads/Hewes-Redfisher-18.pdf>

<https://www.thehulltruth.com/boats-sale-wanted/883031-2010-hewes-redfisher-18-only-217-hrs.html>

<https://www.popyachts.com/flats-fishing-boats-for-sale/hewes-redfisher-18-in-hollywood-florida-133966>

<https://d1h6cla1qbh6o4.cloudfront.net/Listing/196284/6776422L.jpg?2>